



Doris Wu, Ph.D.

National Institute on Deafness and Other Communication  
Disorders (NIDCD), NIH



## Regional specifications and functions of the vestibular system of the inner ear

We rely on the inner ear to hear and to maintain balance. Formation of this organ is a complex process that occurs in a precise temporal sequence. Any missteps in this process will most likely result in some degree of dysfunction affecting the abilities to hear and maintain balance. I will discuss the molecular cues for regional specification of the vestibular system. By understanding the normal development of the inner ear at a molecular level, we may help to design better strategies to alleviate hearing and balancing disorders.

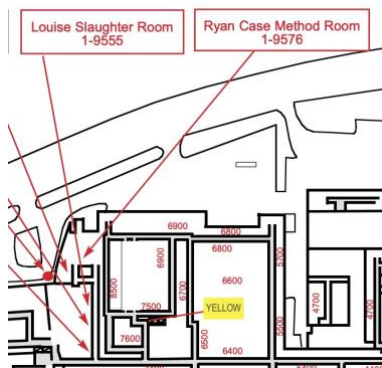

May 20, 2024 at 1pm

*Ryan Case Method Room 1-9576*

<https://rochester.zoom.us/j/92843643143>